



Company Reg no. 2001/000705/08

P O Box 1502 HOEDSPRUIT 1380
Unit 14 Safari Junction
Main Street Hoedspruit

Tel: 015 793 0267
Fax: 086 684 0514
Email: admin@raptorsviewhoa.co.za

FIRE MANAGEMENT PLAN

1. INTRODUCTION

The intention of this plan is to prevent loss of life and property in the event of a fire on the Estate.

2. FIRE HAZARDS

All owners and tenants should be aware of the following dangers:

LIGHTNING – usually occurring during summer months.

VELD FIRES – usually occurring during winter months.

HOUSE FIRES – both internal and external from fireplaces, gas installations, and braais, etc.

ELECTRICAL FIRES – these may be caused by faulty lights, plugs, appliances, multiple extensions.

3. PRECAUTIONARY MEASURES THAT WILL PROTECT OWNERS AND THEIR NEIGHBOURS

- Familiarise yourself with the location of the nearest Fire Hydrant (refer to Appendix 1 for these details)
- Every home owner must ensure that the area immediately surrounding their property is cleared and overhanging branches cut back from the thatch by the end of June every year. Bush clearing must extend for at least 20m from all sides of the house. Absentee owners to also please make sure that their managing agents are aware of this requirement.
- Annual servicing of fire extinguishers. This is also a requirement of most insurance companies. Currently the service is offered by Phalaborwa Fire and General, situated in the Spar/Leadwood Centre. Their e mail address is service@phalaborwafire.com and contact number 062 759 4956. The current annual cost is approximately R100.
- Fire Hoses/Reels need to be serviced and checked to ensure that the fittings have not corroded or damaged. Equipment must be placed away from the house but easily accessible.
- It is useful to have garden hoses connected to a garden tap for fast response in the case of a veld fire, especially during the dry winter months.

4. WHO TO CONTACT

First and foremost, contact Estate Management on the 24/7 number 071 675 2525.

Section fire monitor	
Main gate security	015 793 1663
Farm Watch	072 310 0032
Town Watch	082 414 0554
Hoedspruit SAPS	015 799 4000
Hoedspruit Fire Brigade	015 793 0536
Security Control Room	072 806 4868
Hoedspruit Emergency Services (in case of any injuries)	072 170 0864
Houses immediately adjoining the source of the fire	

The names and telephone numbers of Fire Monitors for the various sections, together with the Stand numbers, are listed in Appendix 2.

Please ensure that you are fully aware of the Fire Monitors who represent your home.

All Fire Monitors are required to attend an induction course to have some fire prevention/fighting knowledge as well as where the necessary equipment is and how it should be used.

5. MEASURES IN PLACE TO PREVENT THE SPREAD OF FIRE

- Roads around the estate are to be kept clear at all times and these will act as a fire break as well as fast access for emergency vehicles.
- Veld monitoring checks are done annually by professionals and, should it be deemed necessary, the Estate Manager in consultation with the Directors, may be required to carry out controlled burns should the fuel load become too great.
- A 2500 litre water bowser is located at the pump station 1.
- A bakkie fire fighting unit is located at Pump Station 2 opposite Bateleur Road.
- Fire hoses available at both Pump Stations to fit the Fire Hydrants, from which the fire fighting equipment can be refilled. Key spanners are also available at the Pump Stations.
- Fire Monitors are provided with a key spanner for the fire hydrants.
- Management to ensure that the keys for the hydrants are readily available at all times, especially in the dry winter months.
- Hand held fire beaters are available at the pump stations. However, management suggest that each house has one or two handy for emergency veld fires.
- Fire monitors will be issued with fire alarms, strong enough to cover houses in their sections. Management will ensure that these are serviced or checked annually before the dry season.
- Water filling points are available at both Pump Stations.

6. OWNERS PROCEDURE IN EVENT OF FIRE

After making the initial first contact with those who will handle the fire, proceed with the following:

- Try to remain as calm as possible.
- Allow the response teams to take control.
- In the meantime, if possible make use of fire extinguishers and hoses to control the blaze before it reaches the thatched roof.
- Remove all gas bottles from the home and disconnect any gas pipe into the house.
- Move vehicles away from the house and surrounds, making sure not to block any access for emergency vehicles.
- Only if you are 100% sure that it is safe to do so, remove your more valuable items. Remember however, that thatch burns incredibly quickly and these things can all be replaced – your life cannot be.
- Before trying to put out a veld fire, check the wind direction and ensure that you are not going to try and take action with the wind blowing towards you. Use beaters and a hose to try to stop it getting to the house.
- In the case of a veld fire, spraying the grass with water in close proximity to buildings may discourage it from getting too close to the house. However, be mindful of water pressure being required by the response teams.

7. FIRE MONITORS PROCEDURE IN THE EVENT OF A FIRE

- Immediately on receiving a call from an owner, make sure that the necessary information is obtained e.g. Stand number, house or veld fire, owner's telephone numbers (landline and cell), check for any injuries etc. (Appendix 4)
- Notify the Estate Manager, security, Farmwatch and the fire department.
- Hoedspruit and the Airforce base.
- Sound the alarm.
- Arrange for help from other local houses.
- Notify adjoining house owners of fire in case of the fire spreading.
- Fire Monitors will be issued with a list of all the house numbers in their relevant section.

Appendix 1: Fire Hydrant Position

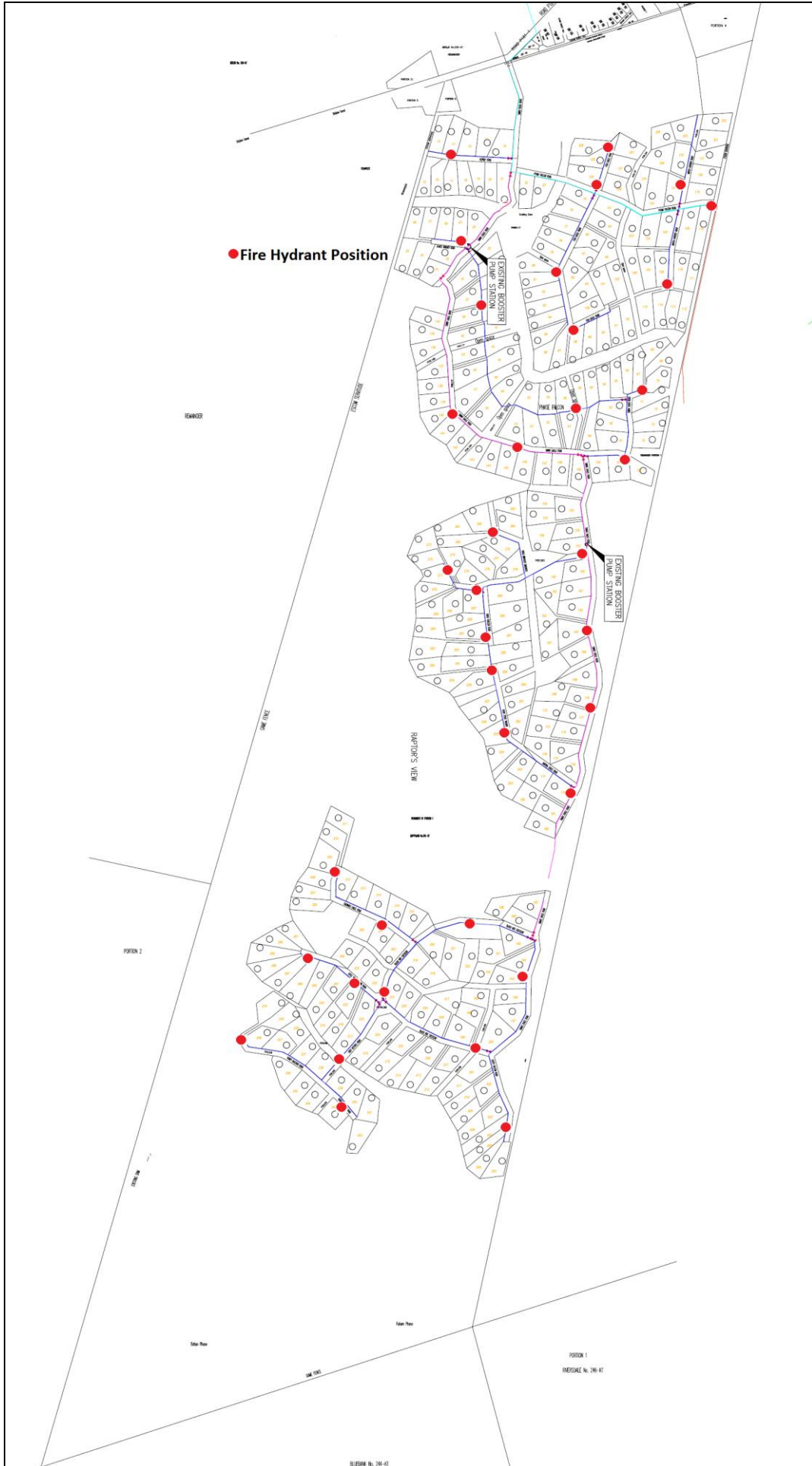

Appendix 2: Fire Monitors

In accordance with the new Protection of Personal Information Act the phone numbers of the fire monitors may only be used for this purpose. Use for any other purpose will be seen as a breach of the POPI Act, as permission for use of their numbers was given for this purpose only.

Section 1	Martin Gagnon RV111	John Blandy RV 125	Kyle Kraidy RV 124
	+1 867 445 6064	082 388 8878	083 278 2849

Section 2	Danie Erasmus RV 24	Hendrik and Irma Leyden RV 134	Tony Gunstone RV 39
	072 394 4035	072 394 4035	083 990 6062
	Liesl Erasmus RV 24		
	078 456 3856		

Section 3	Bertie Vorster RV 156	Ryan Forder RV 173	Johan de Villiers RV 262
	082 926 0718	082 332 9149	082 922 2759

Section 4	Heidi Anderka RV 189	Janine Scorer RV 299	Yvonne Hill RV 193
	082 870 3051	083 266 0703	082 738 6480

Appendix 3: Fire Monitor sections

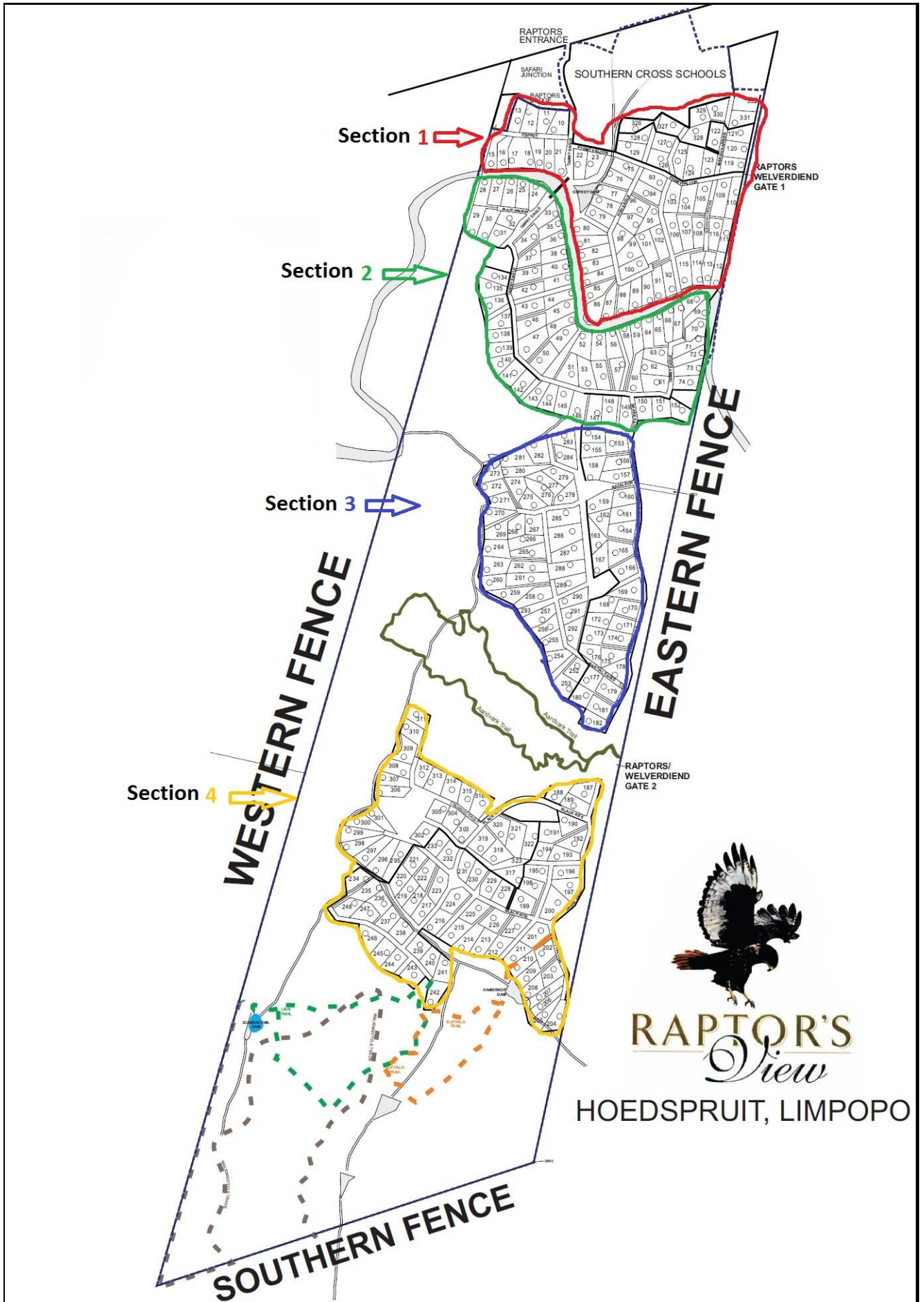

Appendix 4: Important Numbers

Estate Management	071 675 2525
Main Gate Security	015 793 1663
Hoedspruit SAPS	015 799 4000
Farm Watch	072 310 0032
Town Watch	082 414 0554
Hoedspruit Fire Brigade	015 793 0536
Canyon Risk Control Room	072 806 4868